

# FLOVAC® LINER INSTRUCTIONS FOR USE



1 Check the type (with or without gelling powder) the size, the code and the expiring date on label. Pull the LINER out of the blister packaging.



2 Stretch the LINER properly and gently: this helps the correct positioning in the support container.



3 Insert the disposable LINER bag into the reusable rigid container of the appropriate size.



4 Pay attention that the LINER lid completely fits the whole support jar circumference.



5 If the suction is foreseen with one FLOVAC® container only, close firmly and carefully the TANDEM connecting port by using the specific plug provided.



6 Check the presence of the FLOVAC® system special reusable connector on the hose of the suction source (vacuum regulator or electric suction device) and connect it to the VACUUM port on the lid.



7 Check the system sealing by switching the vacuum regulator or the electric suction device on to depressurize the collection system. The LINER soft bag should completely extend and fully contact with the rigid container inner surface. If this does not happen, do not proceed with the suction but remove the reason that prevents the soft bag from extending or, in doubt, replace it.



8 When the bag is fully extended, connect the patient hose to the white elbow (PATIENT port) and start with the suction procedure.

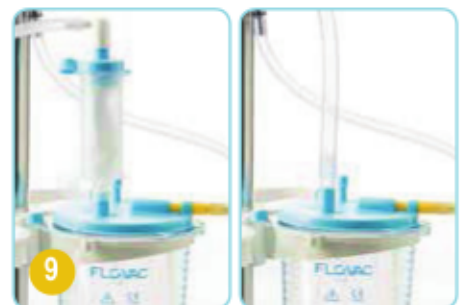

9 In case of suction with hoses having larger diameter or in case of use of the FLOVAC® specimen container, remove the white elbow and connect directly to the PATIENT port to the lid.



10 The procedure to replace the filled up LINER foresees, before extracting it from the support jar, TO CLOSE THE SUCTION SOURCE FIRST, to disconnect the VACUUM port without removing the special reusable connector from the hose, to remove the PATIENT hose and the white connector, then to firmly close the PATIENT port with the specific plug provided.



11 Remove the LINER from the support jar (a small rotation before lifting can help) and dispose it according to the hospital protocol procedures.



12 NEVER USE A SMALLER LINER SIZE PLACED IN A LARGER SUPPORT JAR! Danger of explosion of the LINER caused by the vacuum with consequent suction source and environment contamination!